

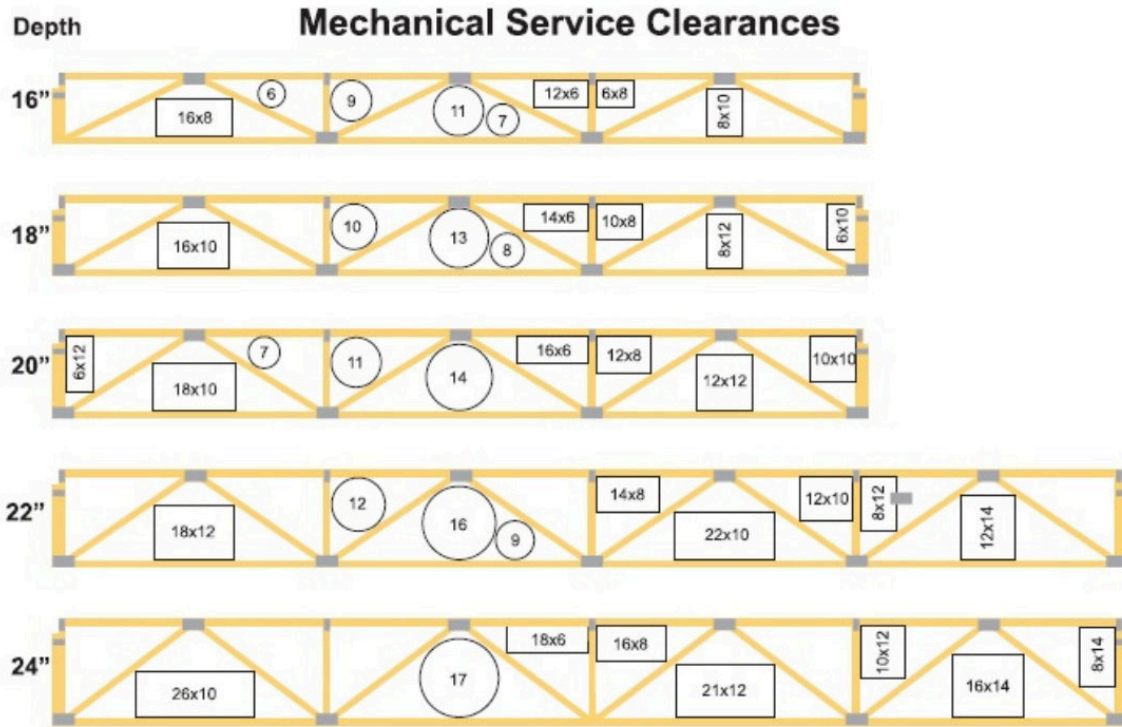

# Span Chart



**Floor Truss Span Chart**

Truss Depth	O.C. Spacing			
	12"	16"	19.2"	24"
12"	20'-6"	20'-6"	20'-1"	17'-11"
14"	23'-11"	23'-10"	22'-1"	19'-7"
16"	27'-3"	26'	23'-9"	22'-1"
18"	30'-5"	27'-11"	25'-4"	22'-6"
20"	33'-11"	29'-7"	26'-10"	23'-10"
22"	36'-3"	31'-2"	28'-3"	25'-1"
24"	37'-11"	32'-07"	29'-7"	26'-3"
40-10-0-5 loading		L/480 LL & L/360 TL Deflection		

Example - A floor truss 18" deep; 19.2" O.C. can clear span 25'4"

WB COMPONENTS LLC  
 8826 76TH STREET S.E.  
 EDGELEY, ND 58433  
 WWW.WBCOMPONENTSLLC.COM  
 701.493.5200 (MAIN OFFICE)  
 701.493.2945 (FAX)

North Dakota Sales: JEFF HAIDER  
 wbcjeffh@gmail.com  
 701.720.5784 (CELL)  
 701.493.5210 (OFFICE)

Montana/South Dakota Sales: GLEN WIPF  
 glen@wbcomponentsllc.com  
 701.830.0505 (CELL)  
 701.493.5214 (OFFICE)

Minnesota Sales: GORDY DYKHOFF JR.  
 wbcgordy@gmail.com  
 218.371.6988 (CELL)  
 701.493.5208 (OFFICE)

